



→ Fold-away lift for light commercial vehicles

## DH-RC.10 • 750 - 1000 kg



The DH-RC.10 is the light-duty alternative offering a **level ride** from the vehicle floor to the ground (and vice versa), and **automatic tilt at ground level**.

While the half-dip ride lifts DH-RP are meant for the cost conscious fleet owners delivering small pallets or boxes and doing general freight and expediting, the level-ride DH-RC.10 (and heavier models) are better suited for **high stack cargo and rolling carts**.

The DH-RC.10 is designed for commercial vehicles up to 12T GVW. A special execution for refrigerated bodies is available as an option [OAP628].

### Lift capacity

CAP	CG	LM
750 kg	600 mm	4.5 kNm
1000 kg	600 mm	6 kNm

### Weights [see pg. 19]

ALU / ALU platform	
1080 mm	275 kg
1280mm	285 kg

Weights incl. CE bumper

# Light fold-away lift with level-ride platform

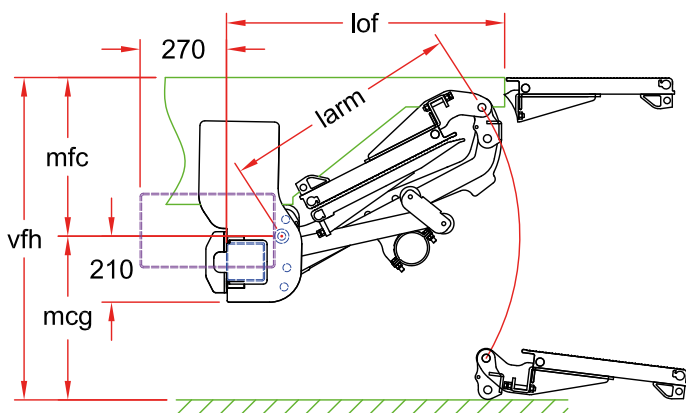

## Fitting dimensions

larm		750	850
vfh max.		1180	1310
vfh min. loaded		900	1000
mfc max.		580	660
mfc min.		350	400
mfcg max.		600	650
lof	at mfc max.	810	895
lof	at mfc min.	980	1070
pd max.		1080	1280

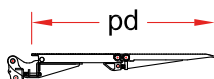

## Technical specifications

Lift frame	120 x 120 mm
Cylinders	1 lift cylinder + 2 fixed stabilisers
Type of ride [see pg. 8-9]	Wedged platform, level ride with automatic tilt at ground level
Platform material	Alu / Alu
Standard platform depths	1080 - 1280 mm
Standard platform widths	2000 - 2200 mm Other widths on request [option OAP303]
Lift arm lengths	750 - 850 mm
Lift arm width	550 mm
Mounting	<ul style="list-style-type: none"> <li>• Rear floor plate [OAM003]</li> <li>• Adapted for refrigerated floor [option OAP628]</li> </ul>
Std. control unit [see pg. 10]	OAE030.BT
Standard finish of the lift frame	Protection PLUS [OAT102]