

# MM.8.M09.S- Mounting instructions

**MB Sprinter 2018 VAN DOUBLE DOOR**  
**SIDE DOOR INSTALLATION | LIFT TYPE: CH104.03.01**  
**RWD | Single Wheel | WB=4325 | OV=xxxx**

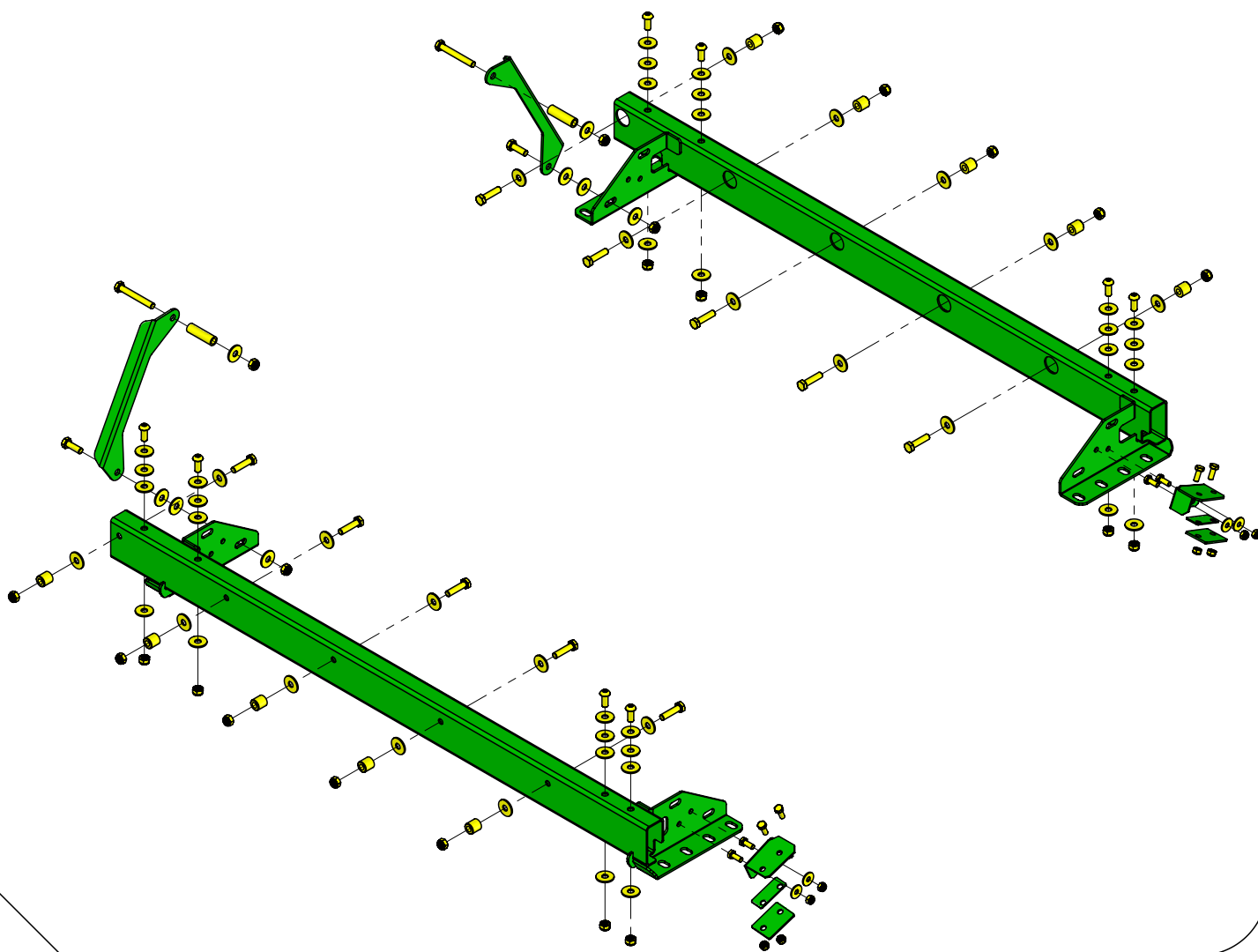
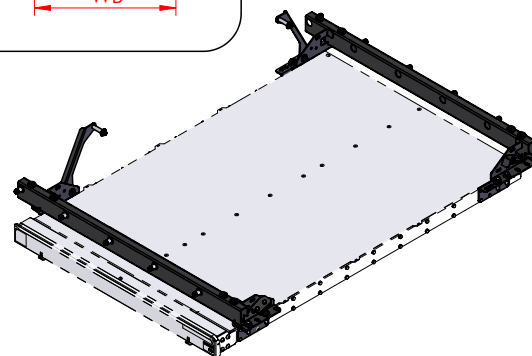
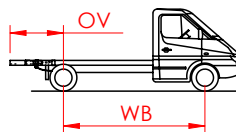

## STEP 1

### Right side vehicle

Assembly is made in advance and has to remain fastened.

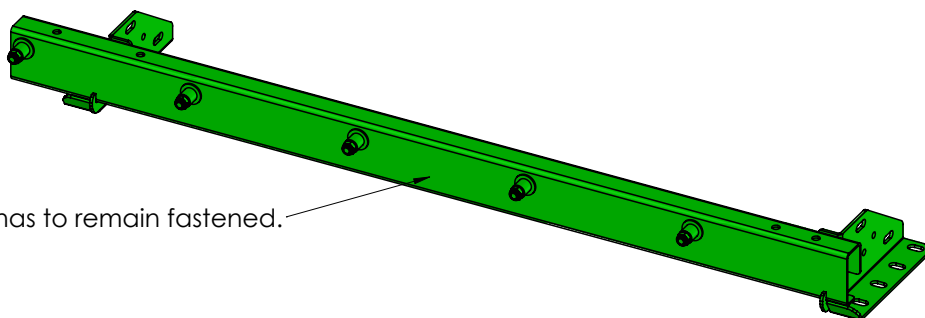

1. Remove rubbers from the bodyshell
2. Insert assembly into the provided holes as shown on the pictures below

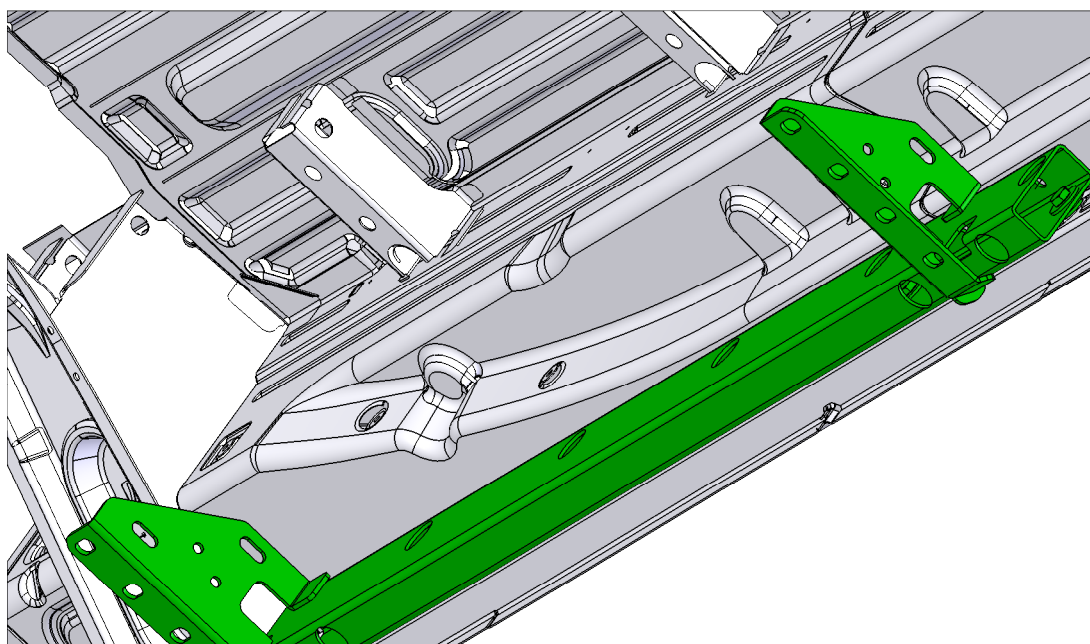
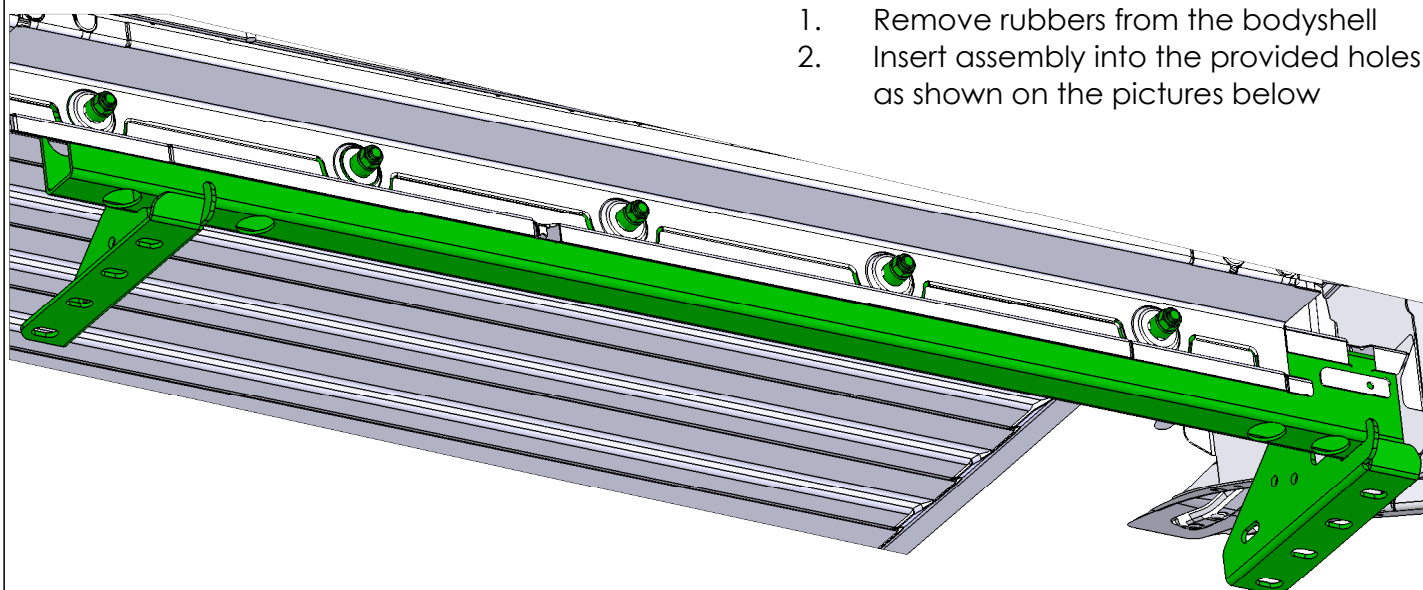

## STEP 2

### Right side vehicle

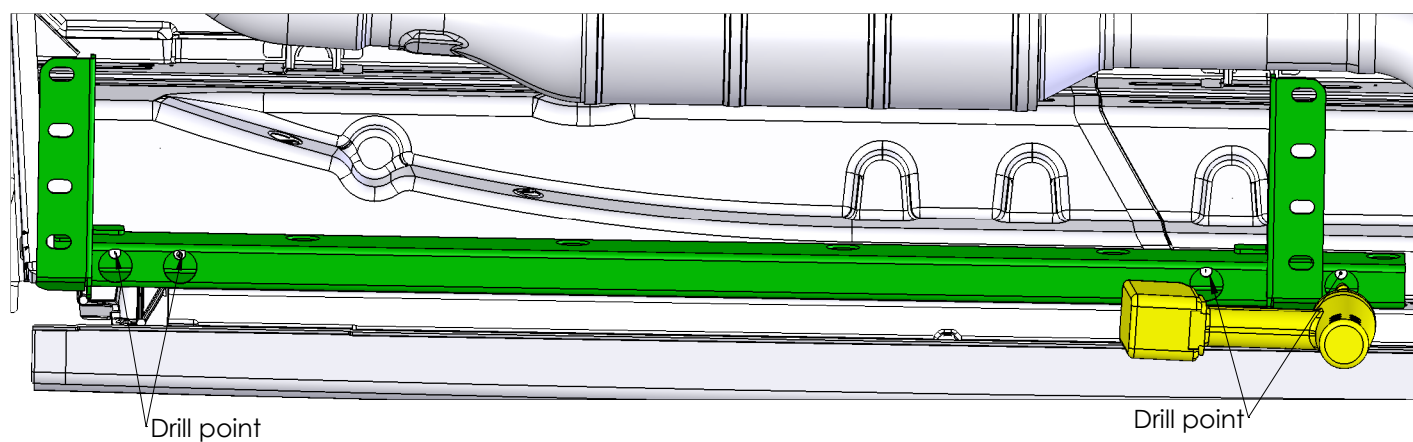

1. Mark the four drill-points through the tube
2. Take out the assembly from step 1
3. Drill the holes (4x Ø11) as shown on the provided pictures
4. Re-insert the assembly

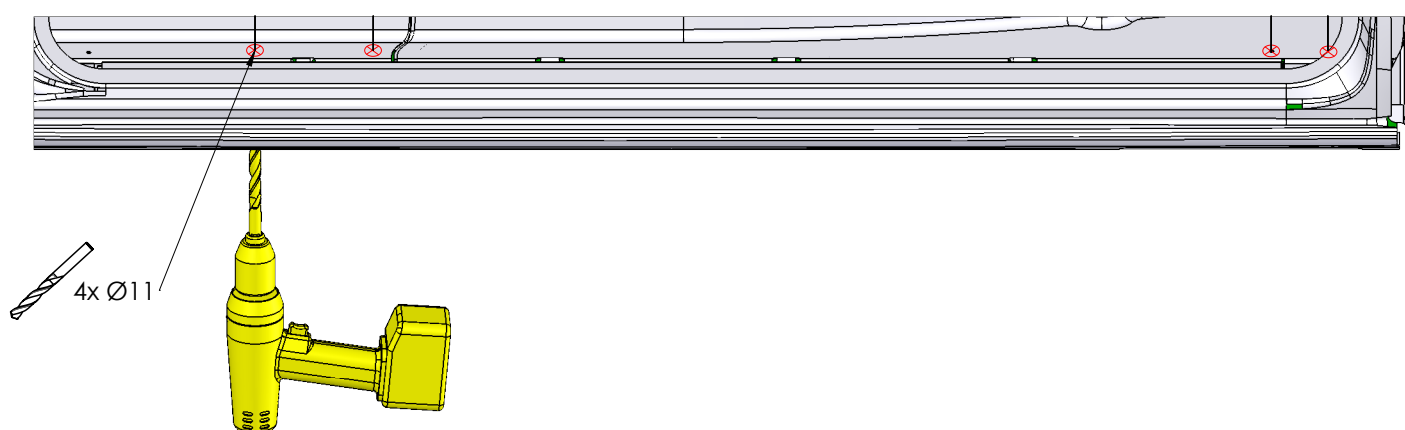

## STEP 3

### Right side vehicle

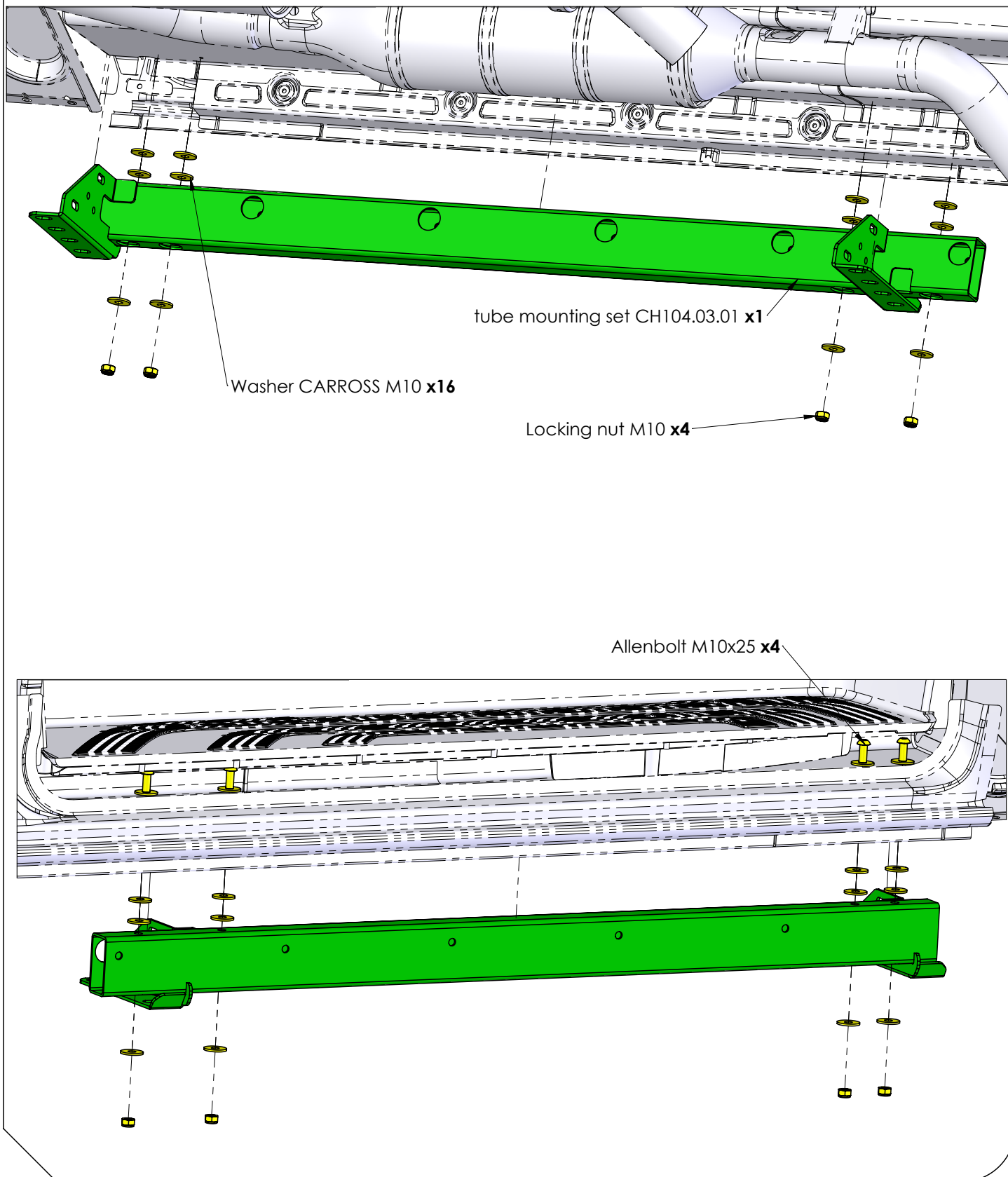



## STEP 4

### Right side vehicle

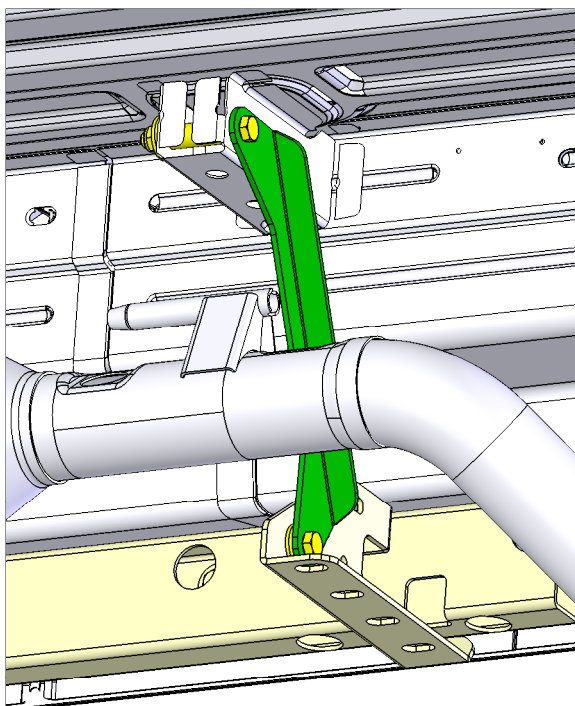
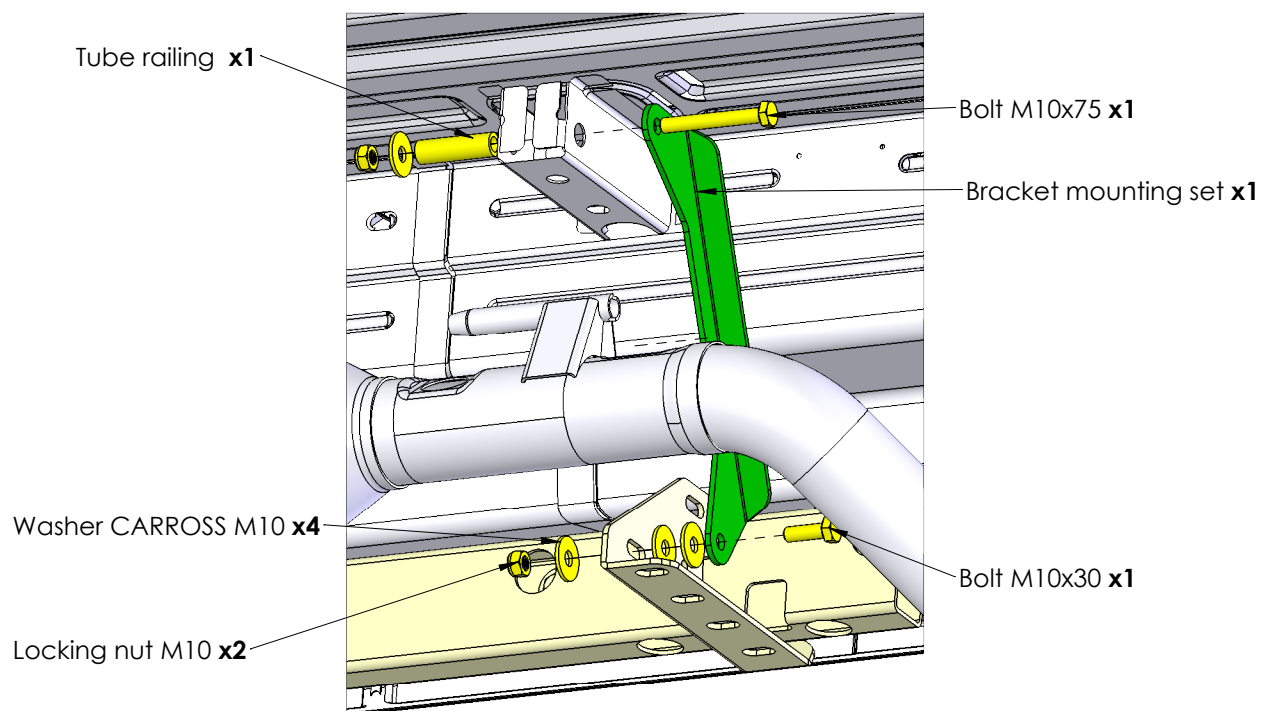

## STEP 5

### Right side vehicle

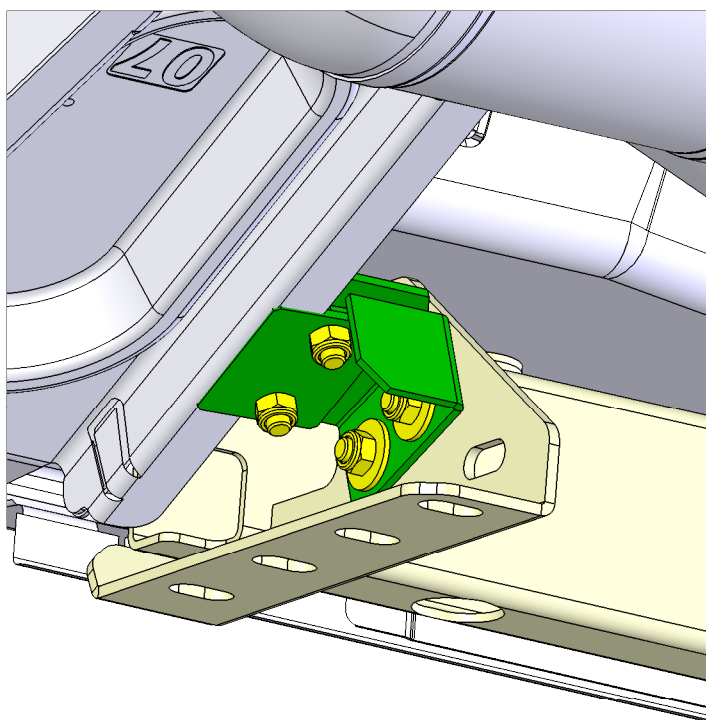
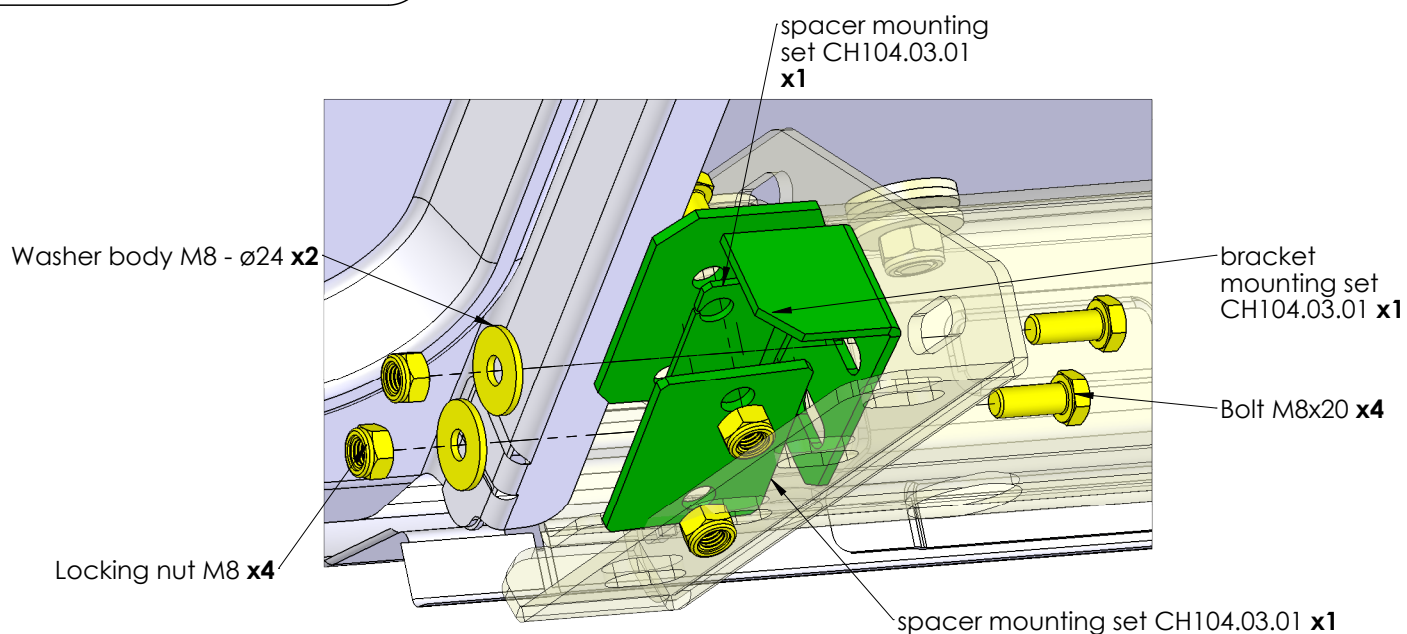

## STEP 6

Repeat steps 1-5 on the left side of the vehicle.

## STEP 7

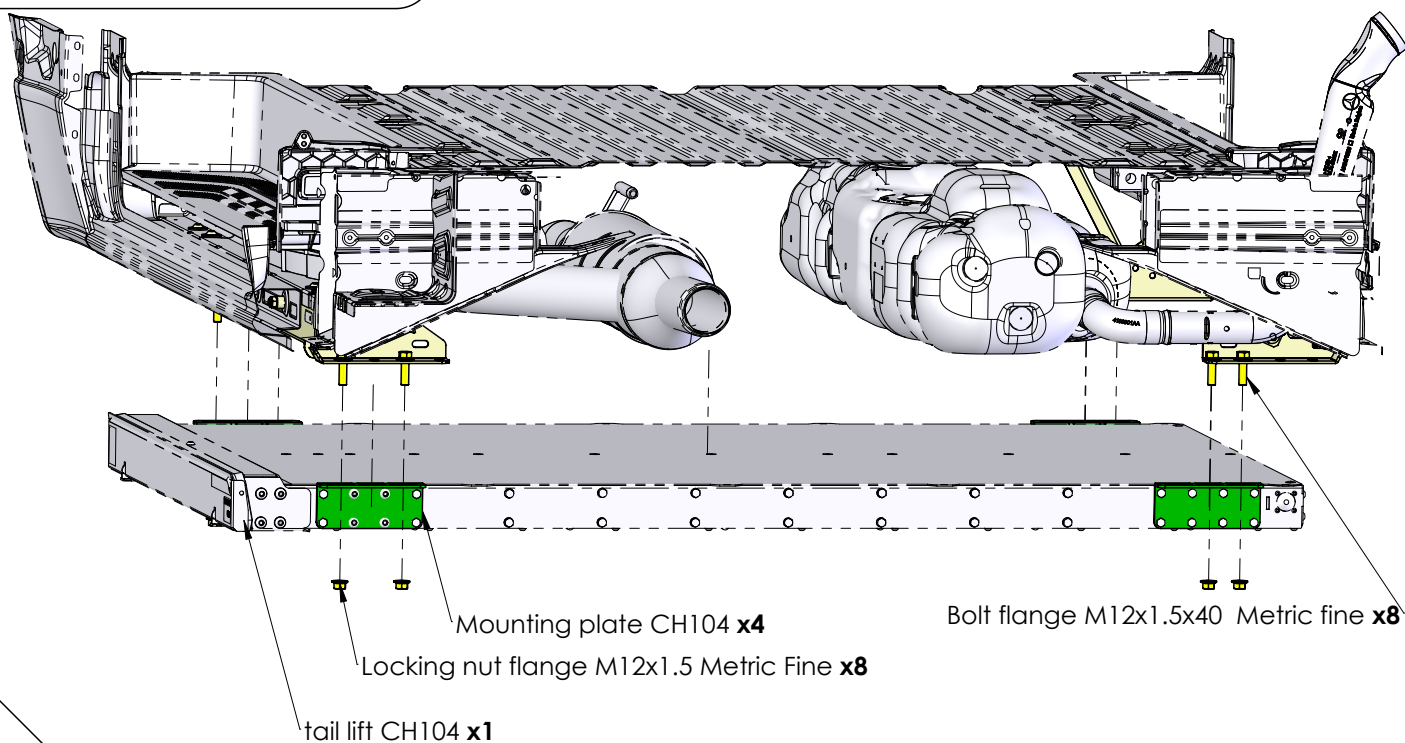

# Overview

