

MM.8.M10.R.S- Mounting instructions

MB Sprinter 2018 VAN

SIDE DOOR INSTALLATION | LIFT TYPE: CH104.03.01

RWD | Single Wheel | **WB=4325** | **OV=xxxx**

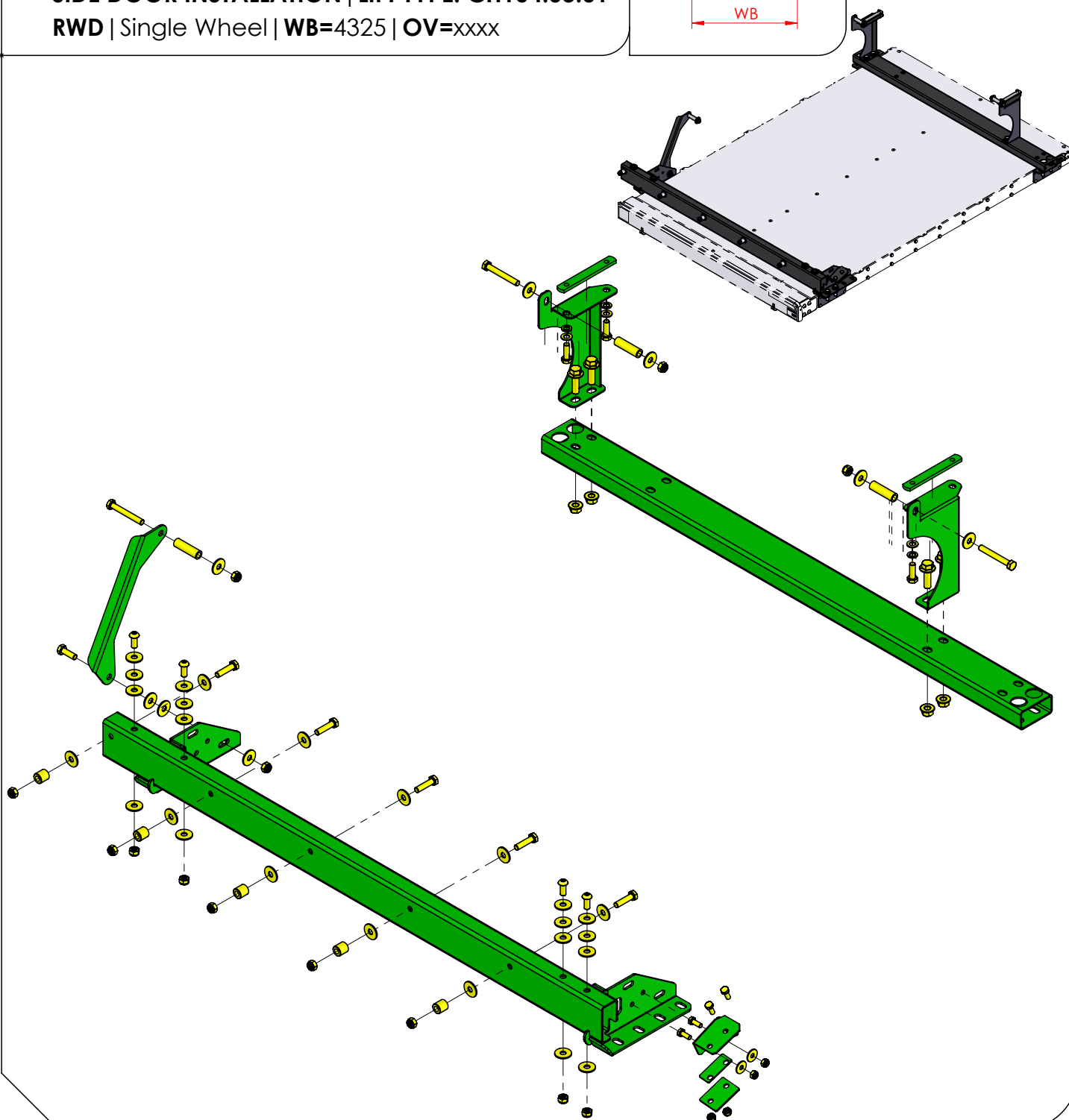
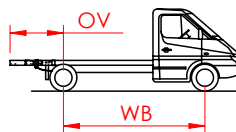

STEP 1

Left side vehicle

fixation plate mounting set CH104.03.01 **x2**

Insert plate as shown

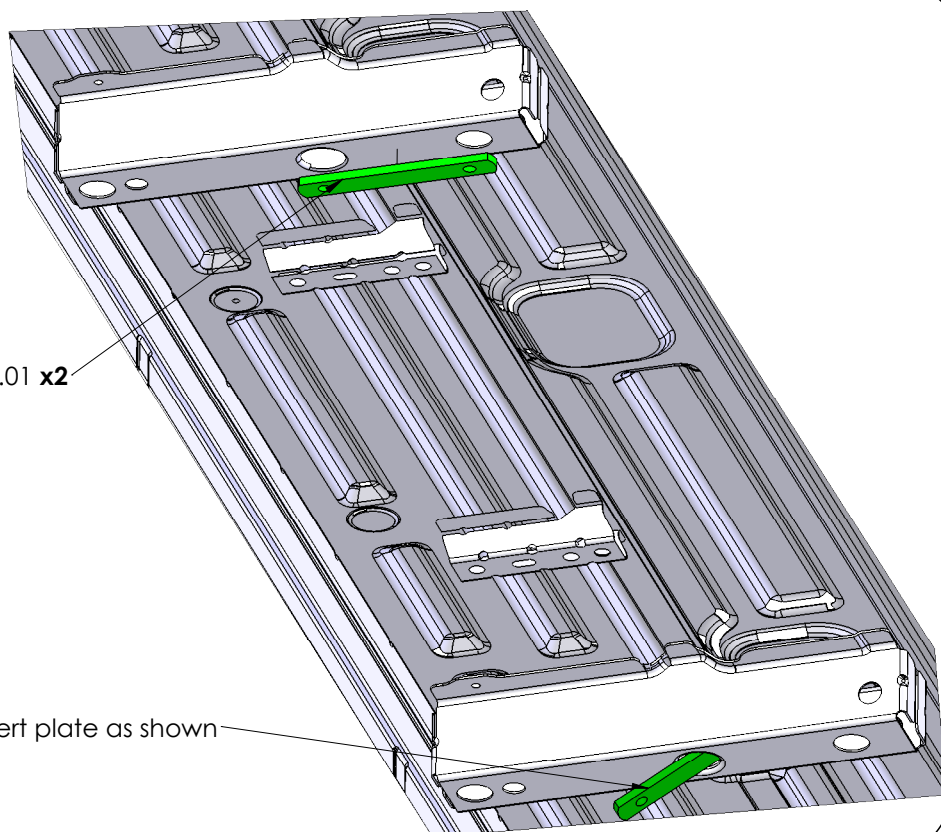

STEP 2

Left side vehicle

bracket mounting set CH104.03.01 **x2**

Washer flat M10 **x4**

Spring washer M10 **x4**

Bolt M10x30 **x4**

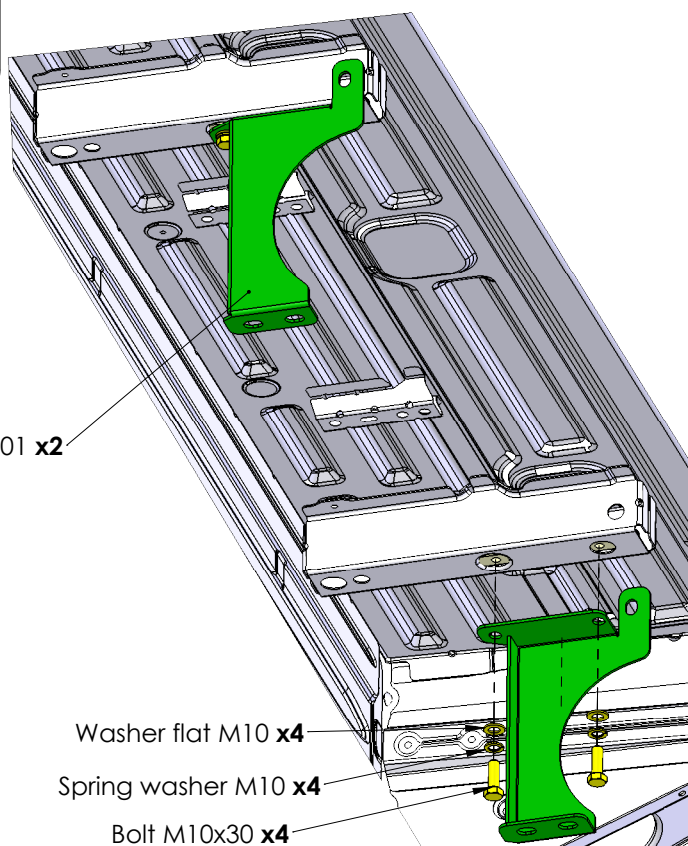

STEP 3

Left side vehicle

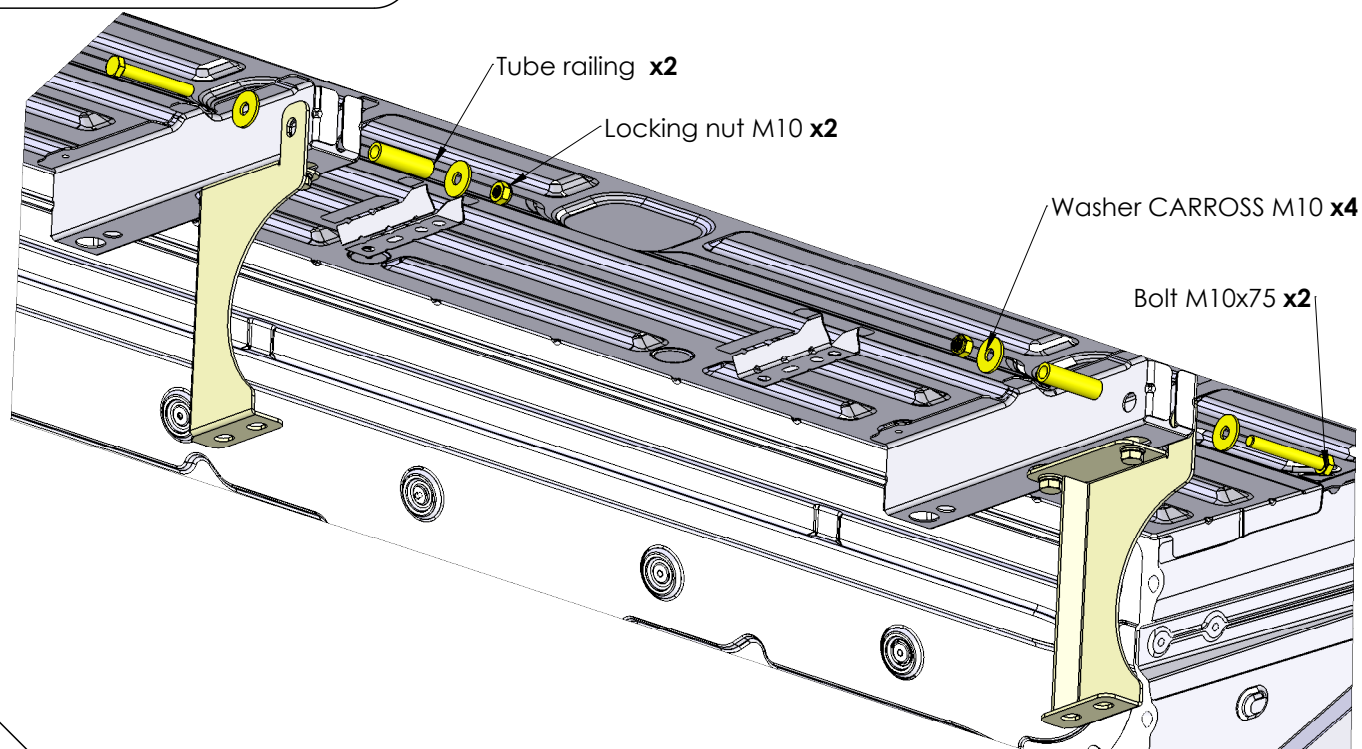

STEP 4

Left side vehicle

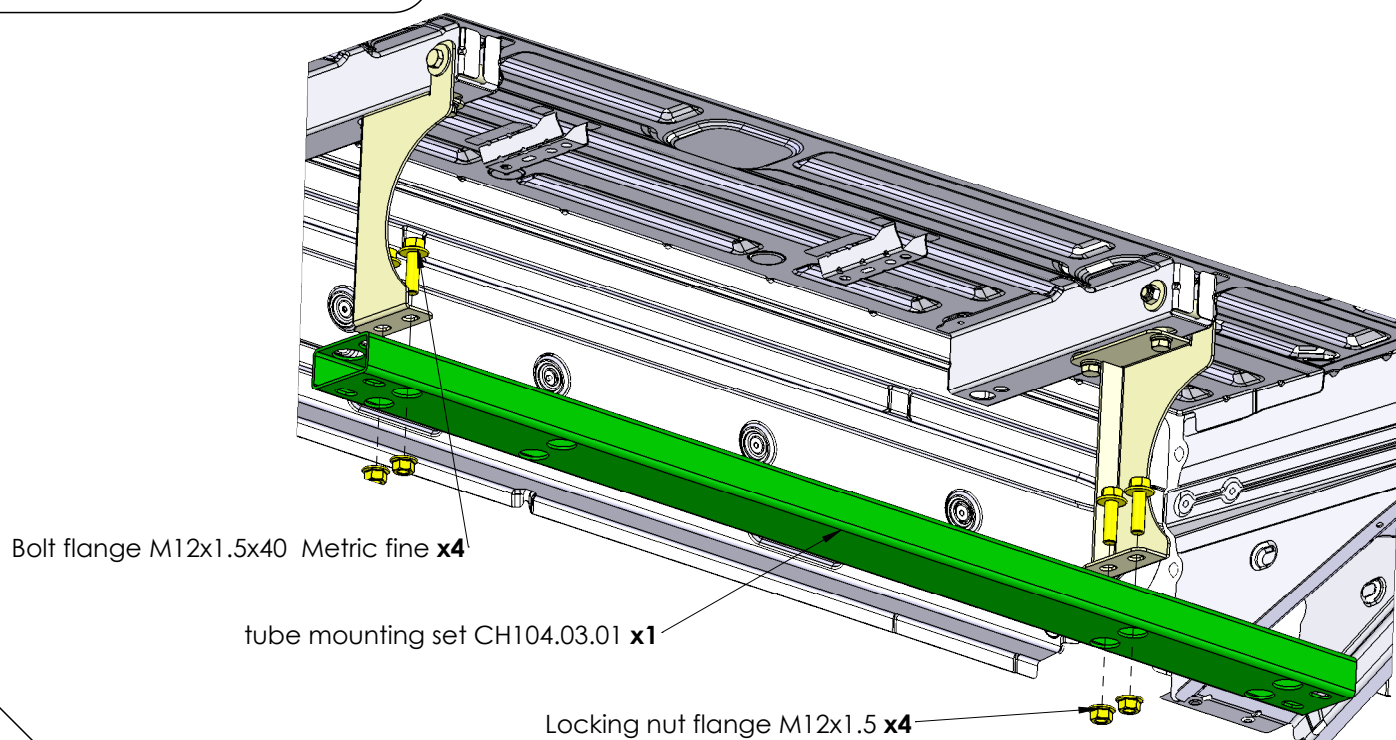

STEP 5

Right side vehicle

Assembly is made in advance and has to remain fastened.

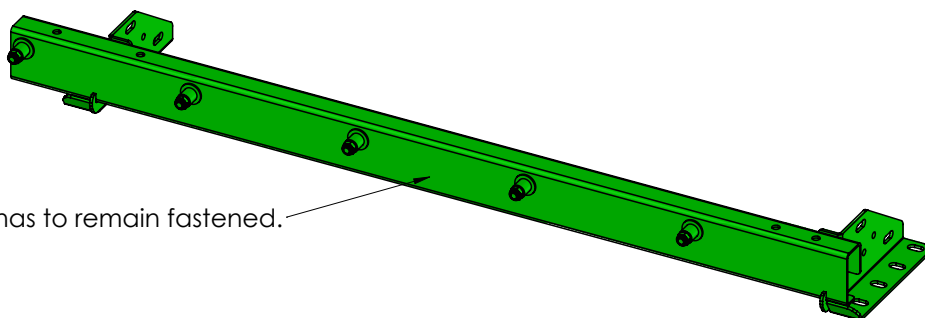

1. Remove rubbers from the bodyshell
2. Insert assembly into the provided holes as shown on the pictures below

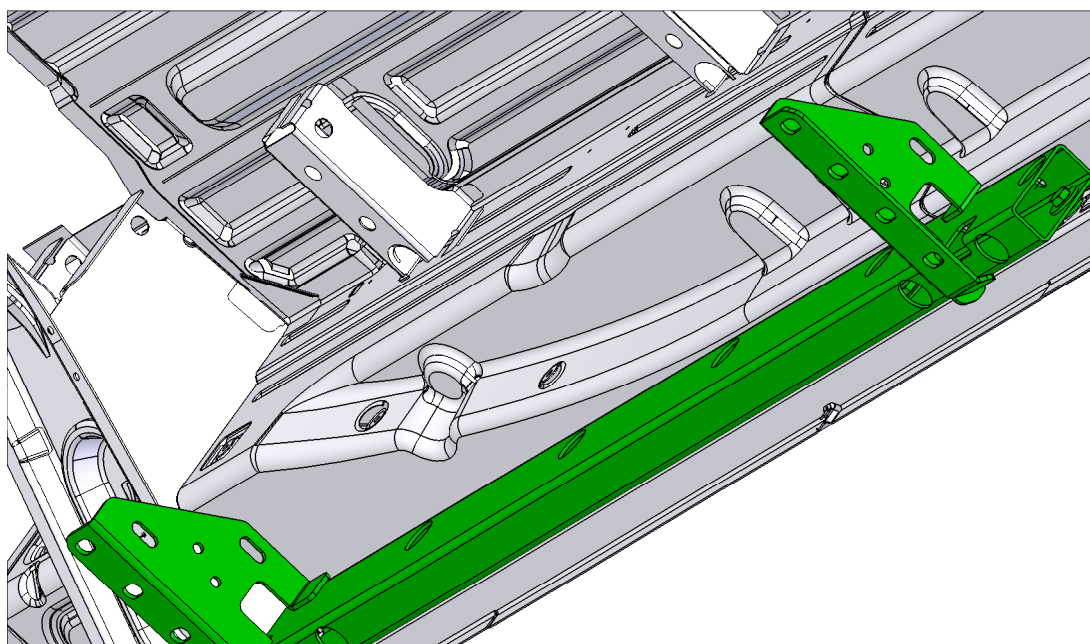
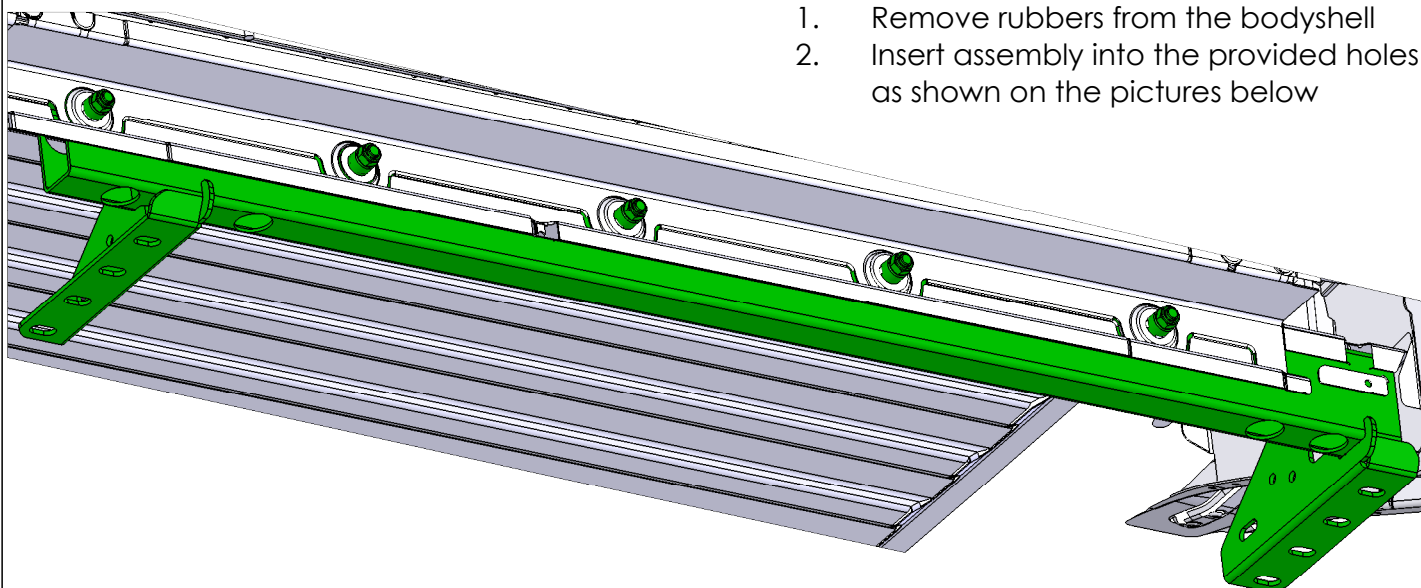

STEP 6

Right side vehicle

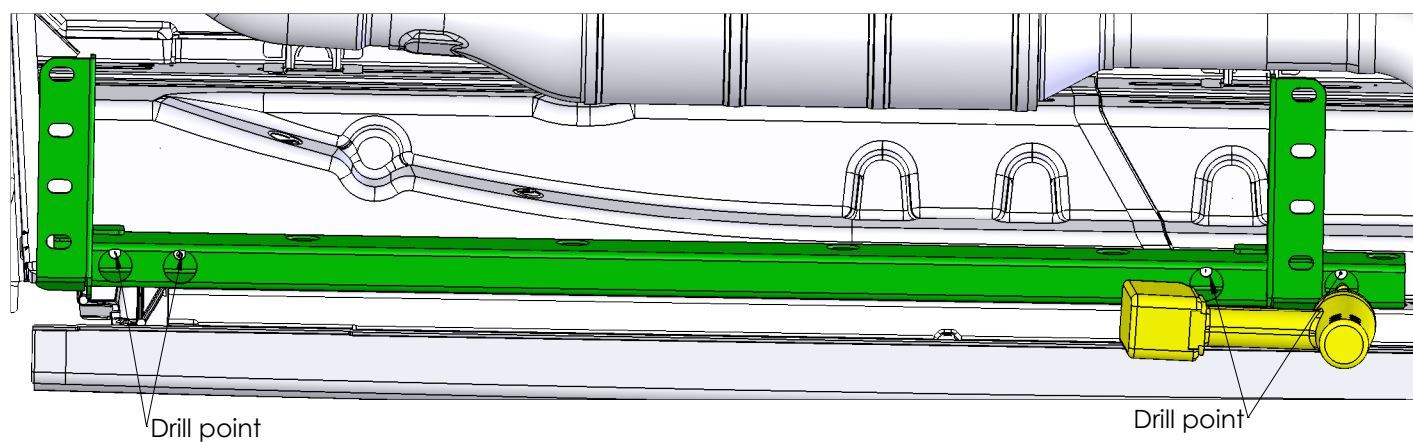

1. Mark the four drill-points through the tube
2. Take out the assembly from step 5
3. Drill the holes (4x Ø11) as shown on the provided pictures
4. Re-insert the assembly

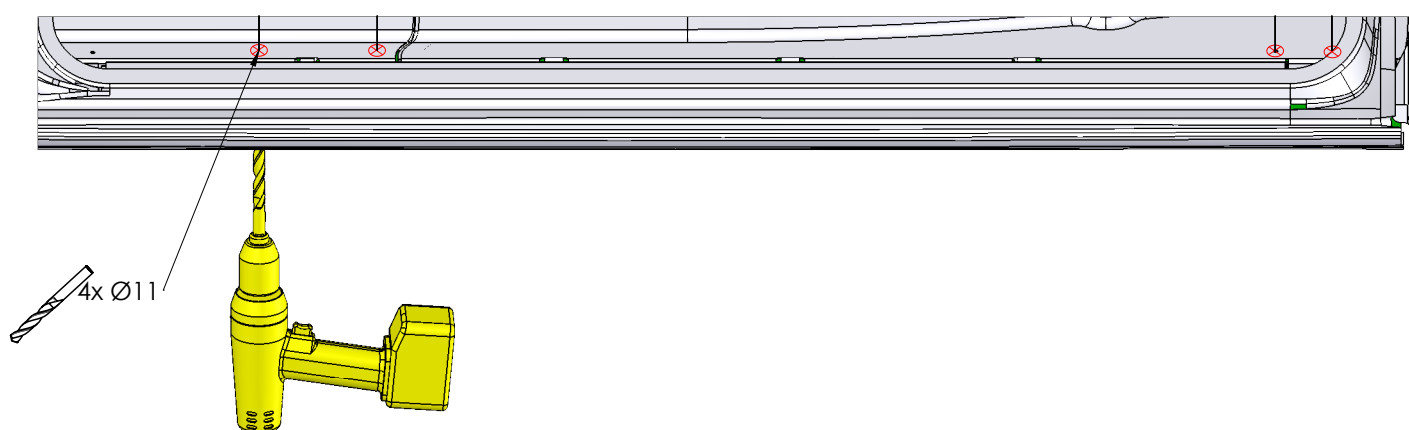

STEP 7

Right side vehicle

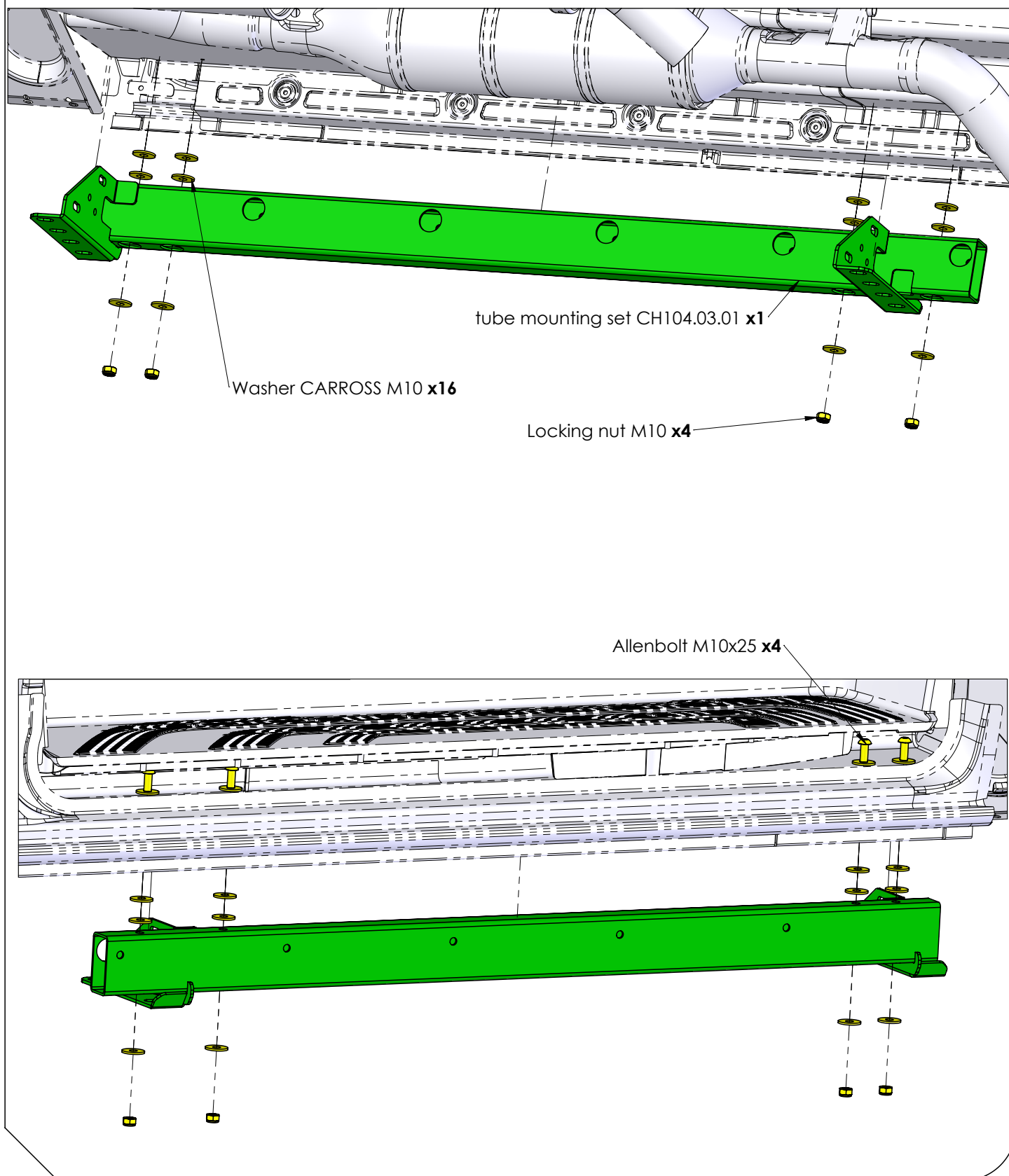

STEP 8

Right side vehicle

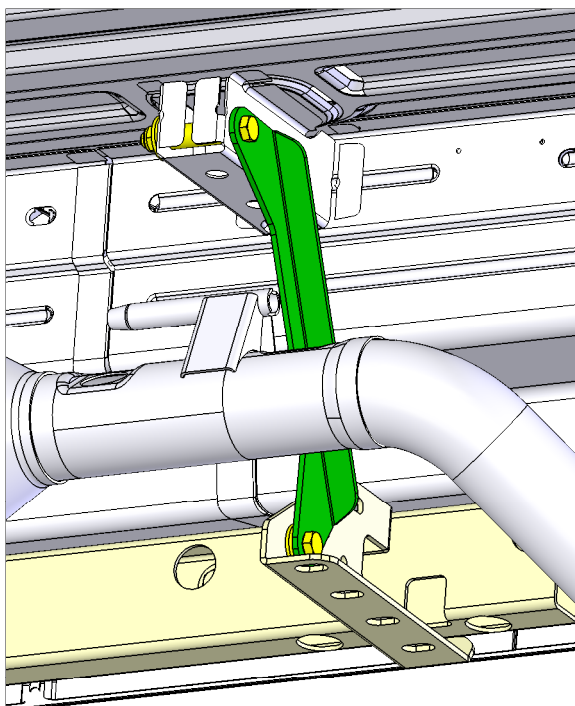
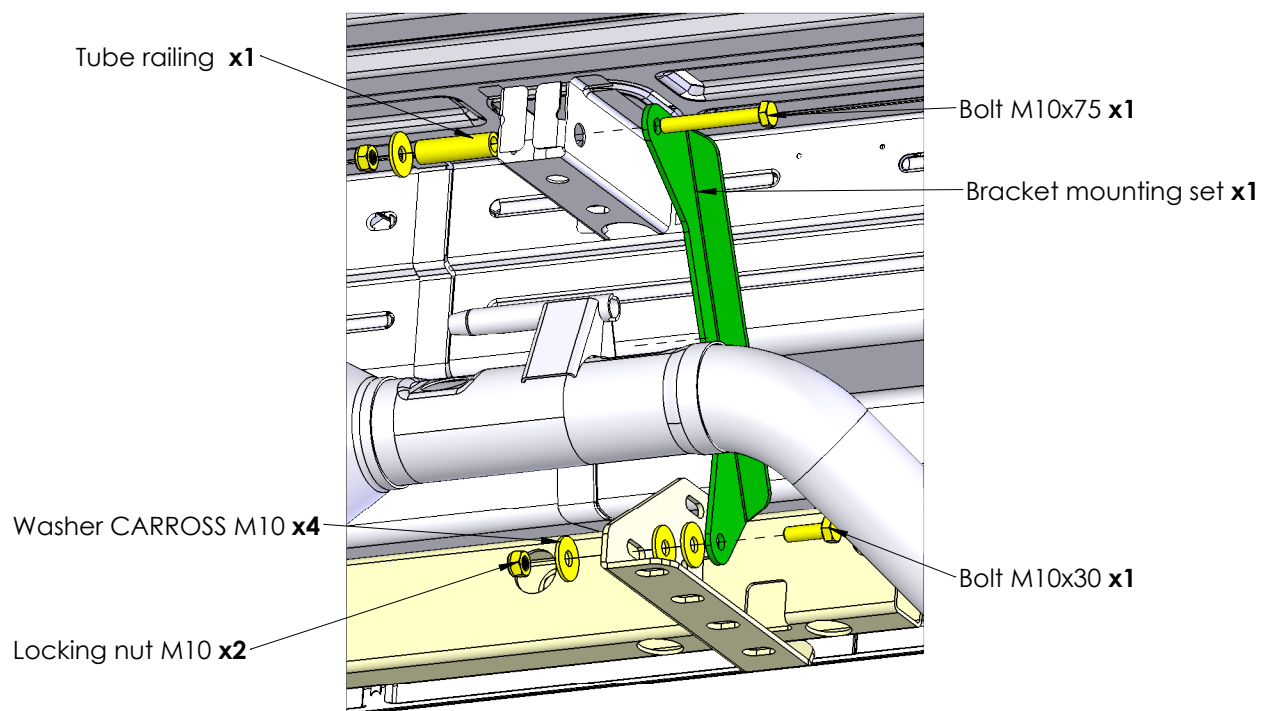

STEP 9

Right side vehicle

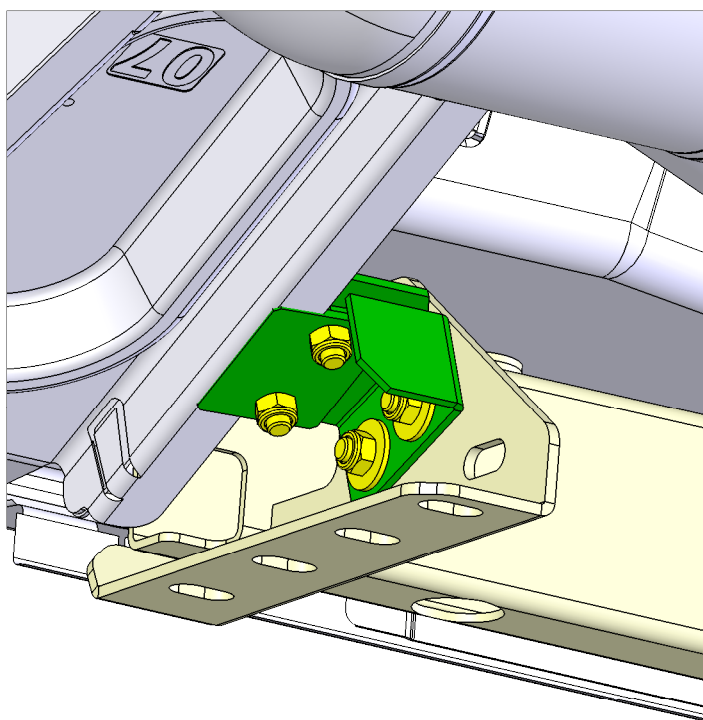
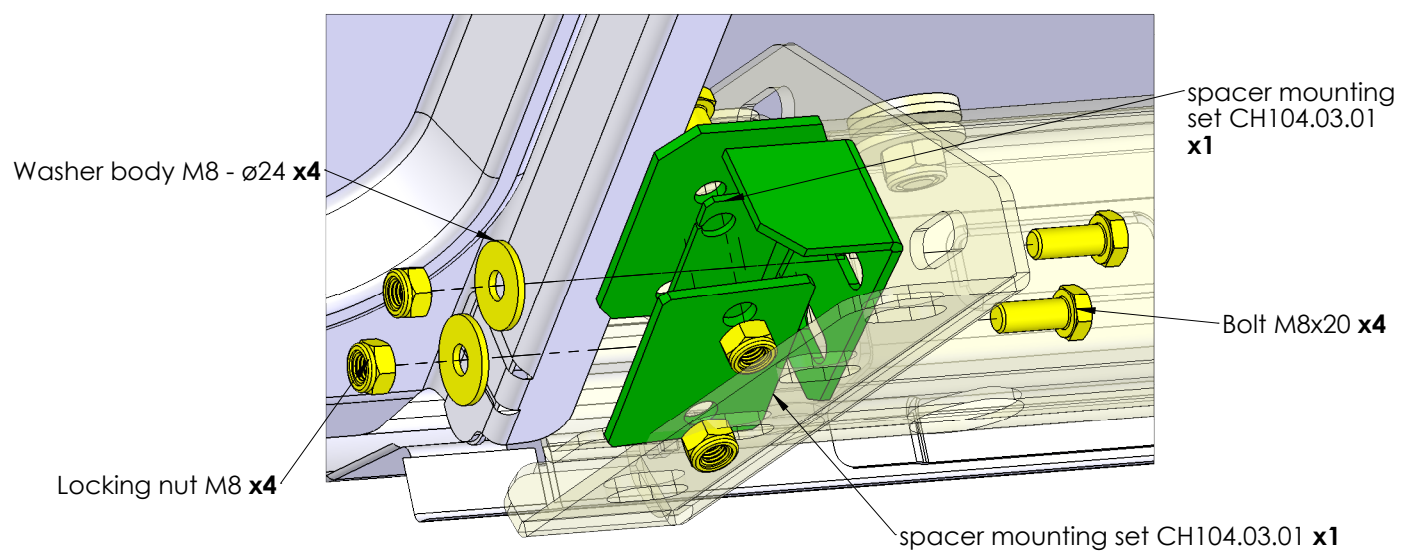

STEP 10

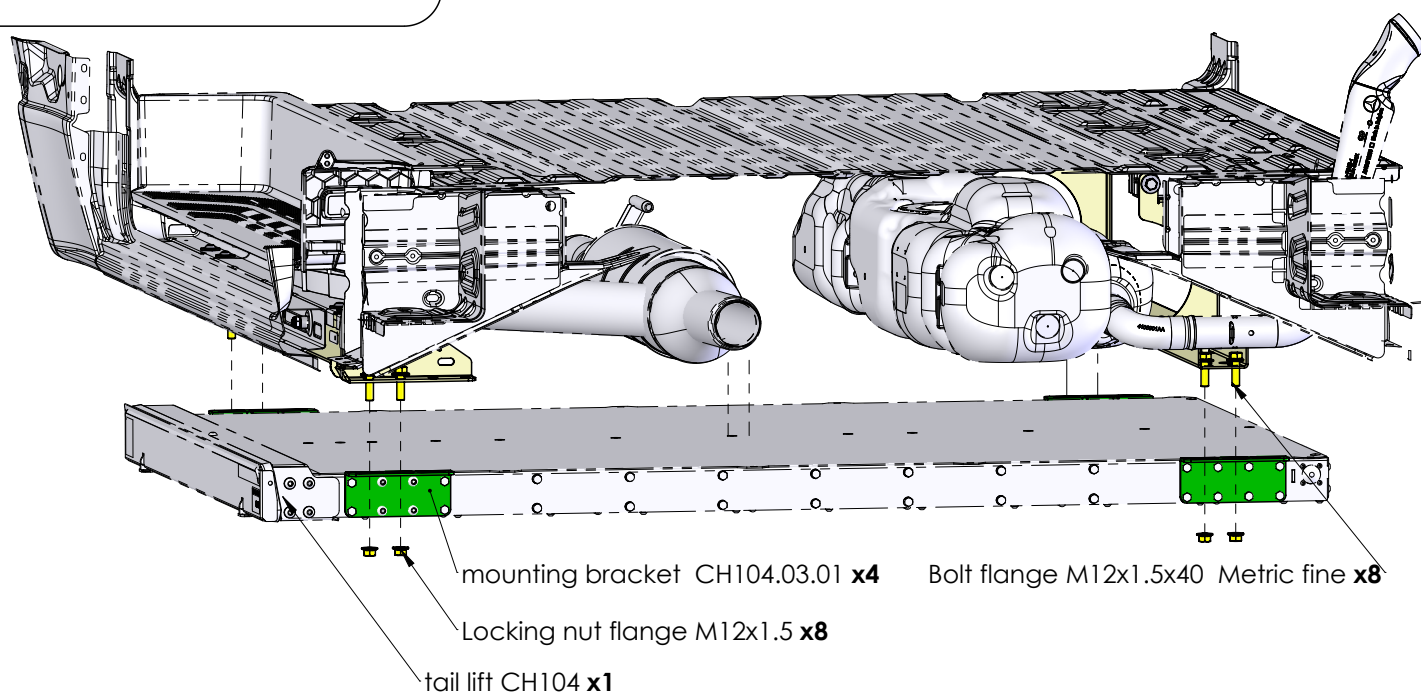

OVERVIEW

